

Landscape Consultancy Services

Edge Hill University: Proposed 25ha Sports Development

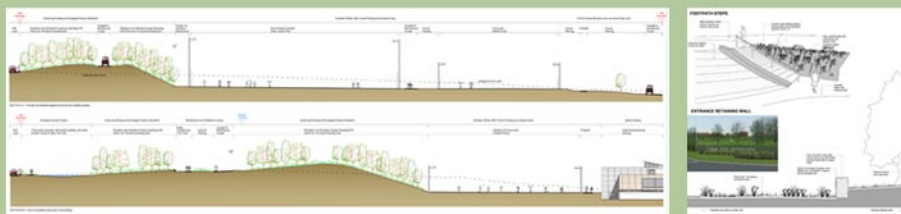

Client: Edge Hill University, Ormskirk, Lancashire

Milieu Landscape Design provided landscape services (Stages A-L) and delivered a new large scale sports development scheme east of the current university campus on a 25 hectre area of greenbelt. Replacing the University's existing sports provision with new high specification facilities, set within new mixed habitats. The client's vision is to provide an inspirational Campus for the future, by providing effective learning and working environments using sustainability as a key driver for development. As part of this vision the University has the opportunity to become a Regional Centre of Excellence in sport and the proposed new sports development will play an major part in the delivery of this vision.

Planning Application submitted: Approved January 2012 - Works Completed 2014 - Project Value: £25m

M ILIEU	people
L ANDSCAPE	places
D ESIGN	nature